

AP2: North Adanac

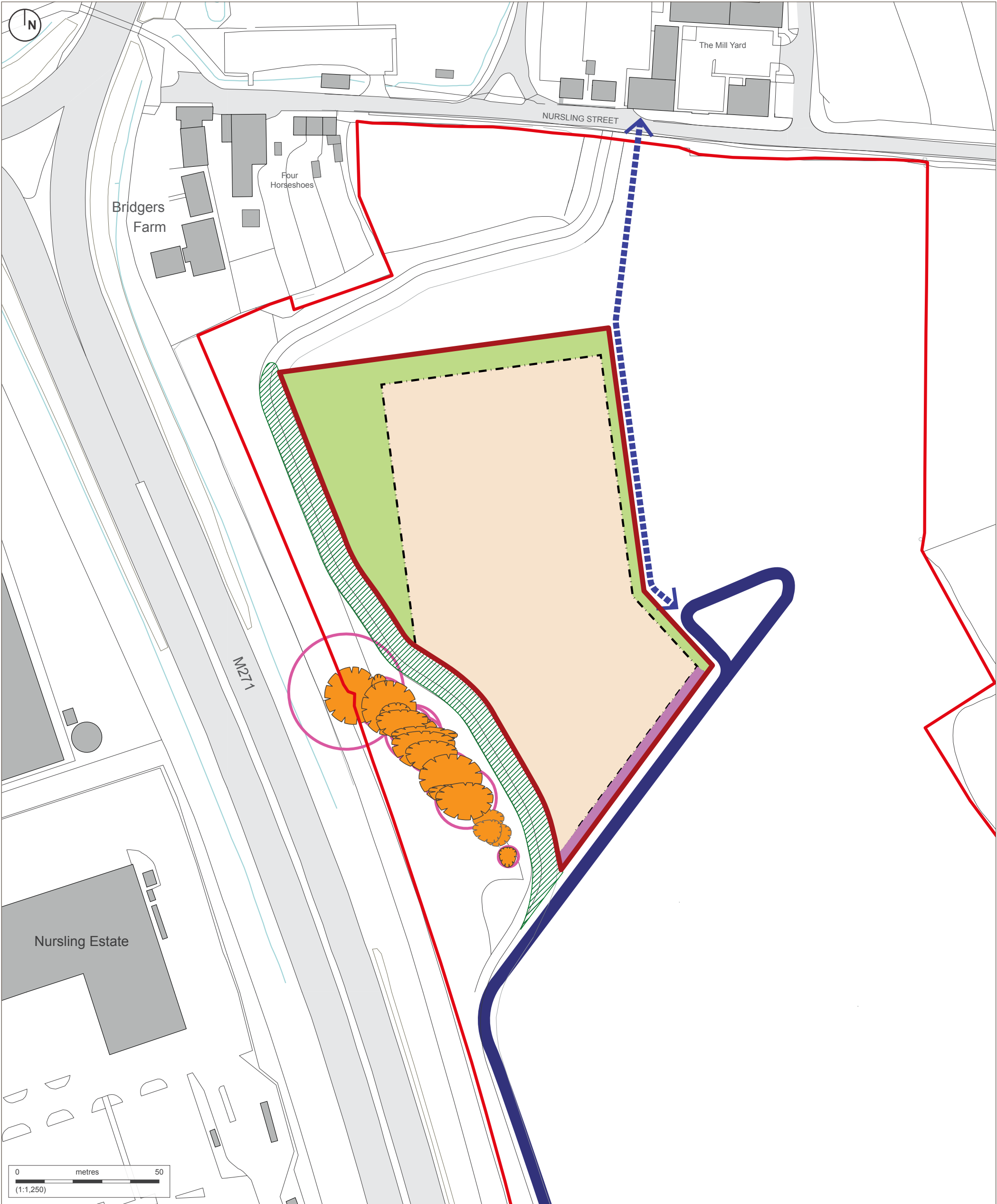

- Adanac Park development framework area
- Development parcel
- Development zone boundary
- Strategic planting
- Retained TPO group of trees and root protection zone
- Access zone (zone in which access will be taken through the strategic planting)
- Indicative footpath / cycle way and emergency vehicle link
- Indicative road position
- Acoustic / landscaped bund

Plans reproduced by permission of Ordnance Survey on behalf of The Controller of Her Majesty's Stationery Office. © Crown Copyright and database right [2013]. All rights reserved. Ordnance Survey Licence number [100020449]. This drawing is for illustrative purposes only and should not be used for any construction or estimation purposes. Do not scale drawings. No liability or responsibility is accepted arising from reliance upon the information contained in this drawing



Project: Adanac Park

Client: Barker Mill Estates

Title: Parcel Parameter Plan

Status: Final

Job No: TRUW2038

Dwg No: AP2-P-5

Date: Jan 2014

Revision: -

Scale: 1:1,250@A3

Author: SR / MF

TURLEYASSOCIATES

turleyassociates.co.uk